

Rinne / channel:

BH 80, beids. perf. / height 80, both-sided perf. / V/E  
BG code: siehe Tabelle/see table:

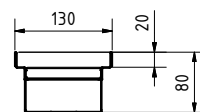

BH 180, beids. perf. / height 180, both-sided perf. / V/E  
BG code: siehe Tabelle/see table:

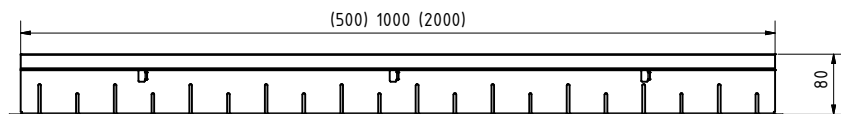
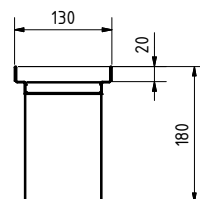
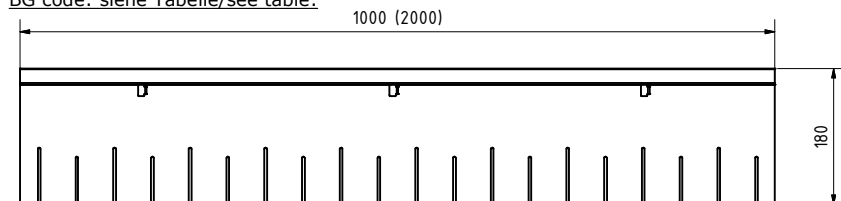

BH 80, geschlossen / height 80, not perforated / V/E  
BG code: siehe Tabelle/see table:

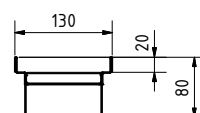
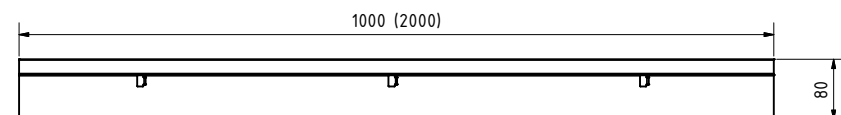

BH 180, geschlossen / height 180, not perforated / V/E  
BG code: siehe Tabelle/see table:

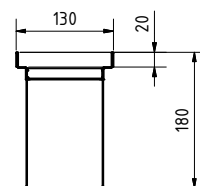
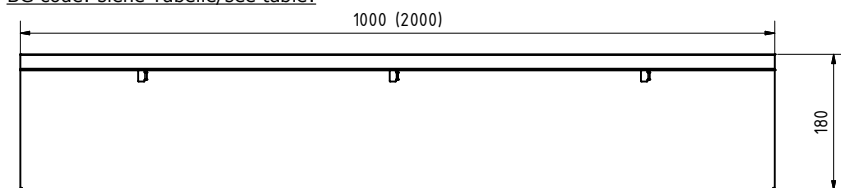

variable BH 80-120, offener Boden / variable height 80-120, open bottom / V/E  
BG code: siehe Tabelle/see table:

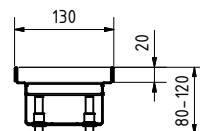
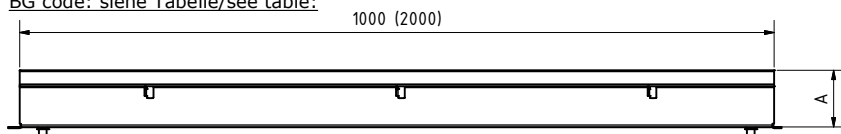

variable BH 120-180, offener Boden / variable height 120-180, open bottom / V/E  
BG code: siehe Tabelle/see table:

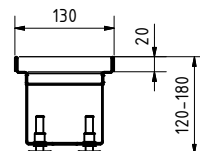
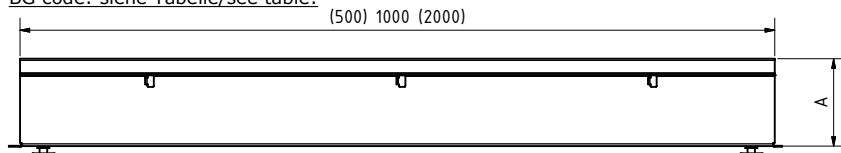

Rinne / channel - Maße / dimensions [mm]					
Typ	Höhe height	Länge length	Gewicht weight	BG code V	BG code E
BG-FA RB 130 perforiert/perforated	80	500	1,3 kg	21013200	21013300
BG-FA RB 130 perforiert/perforated	80	1000	2,6 kg	21013201	21013301
BG-FA RB 130 perforiert/perforated	80	2000	5,0 kg	21013202	21013302
BG-FA RB 130 perforiert/perforated	180	1000	4,1 kg	21013211	21013311
BG-FA RB 130 perforiert/perforated	180	2000	8,1 kg	21013212	21013312
BG-FA RB 130 geschlossen/not perforated	80	1000	2,6 kg	21013251	21013351
BG-FA RB 130 geschlossen/not perforated	80	2000	5,1 kg	21013252	21013352
BG-FA RB 130 geschlossen/not perforated	180	1000	4,1 kg	21013261	21013361
BG-FA RB 130 geschlossen/not perforated	180	2000	8,3 kg	21013262	21013362
BG-FA plus RB 130 offener Boden/open bottom	80-120	1000	3,0 kg	21013231	21013331
BG-FA plus RB 130 offener Boden/open bottom	80-120	2000	6,1 kg	21013232	21013332
BG-FA plus RB 130 offener Boden/open bottom	120-180	1000	3,9 kg	21013233	21013333
BG-FA plus RB 130 offener Boden/open bottom	120-180	2000	8,0 kg	21013234	21013334

Legende / explanation:	
V:	verzinkter Stahl / galvanized steel
E:	Edelstahl / stainless steel

Roste, Abdeckungen / grates, covers:

Gitterrost/ Mesh grating: MW 30/10

BG code: V 24513201 (24513202), E 24513301 (24513302); 2,5 kg (1,3 kg):

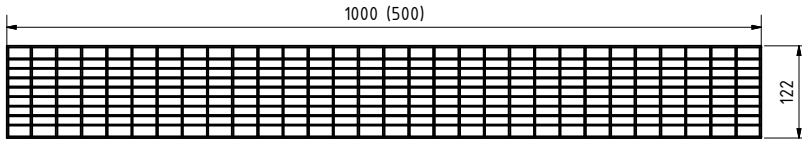

Stegrost / Slotted grating: SW 9/85

BG code: V 24513203 (24513204), E 24513303 (24513304); 1,5 kg (0,8 kg):

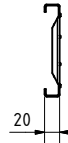
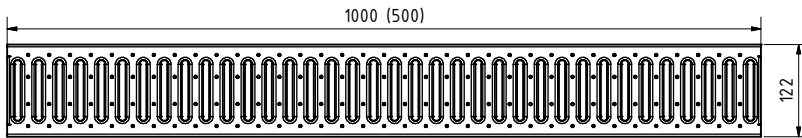

Lochrost / Perforated grating:  $\phi$  6mm

BG code: V 24513205 (24513206), E 24513305 (24513306); 1,6 kg (0,8 kg):

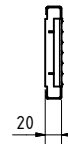
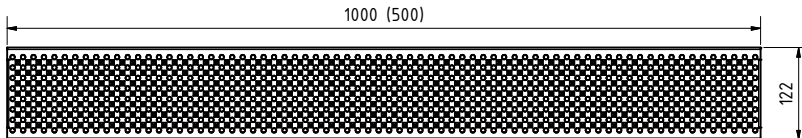

Längsstabrost / Longitudinal-bar grating: SW 10mm

BG code: V 24513207 (24513208), E 24513307 (24513308); 3,9 kg (2 kg):

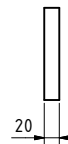
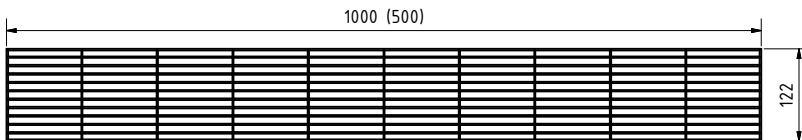

Querstabrost / Cross-bar grating: SW 10mm

BG code: V 24513209 (24513210), E 24513309 (24513310); 4,2 kg (2,1 kg):

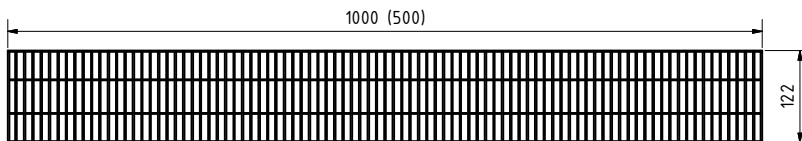

Designrost "Strahlen" / Design grating "ray":

BG code: V 24513211 (24513212), E 24513311 (24513312); 1,4 kg (0,7 kg):

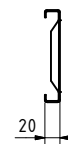
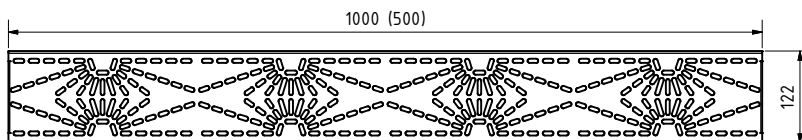

Zubehör / accessories:

Ablaufteil, DN 75, BH 80, geschl. / outlet unit, DN 75, height 80, not perforated  
BG code: V 24913201, E 24913301; 2,6 kg:

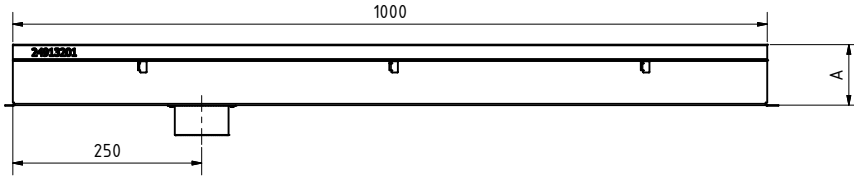

Ablaufteil, DN 75, BH 180, geschl. / outlet unit, DN 75, height 180, not perforated  
BG code: V 24913202, E 24913302; 4,3 kg:

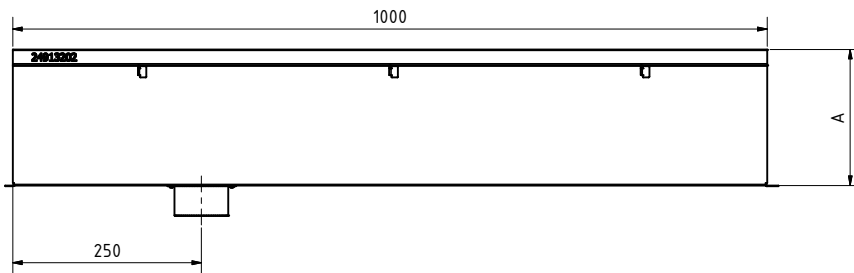

Eckelement BH 80 / corner piece 90° RB 130 height 80  
BG code: V 24913211, E 24913311; 2,1 kg



Stirnplatte BH 80 / frontplate height 80  
BG code: V 24913221, E 24913321; 0,1 kg:

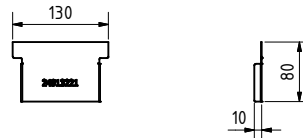

Stirnplatte BH 180 / frontplate height 180  
BG code: V 24913222, E 24913322; 0,2 kg:

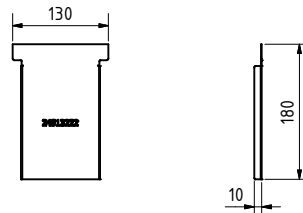

Verschraubungsmaterial (Bedarf je m 2 Stk.) /  
locking device kit (2 pieces required per m)  
BG code: V 24900010, E 24900011; 0,1 kg:



Stichkanal / branch canal:  
BG code: V 37851 (37852), E 37861 (37862); 1,1 kg (2,2 kg):

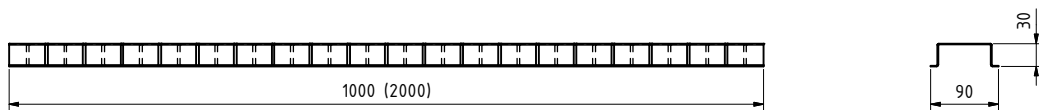

Zubehör / accessories:

Aufsatzelement 250/250 BH 50 /  
gully top 250/250 height 50  
BG code: V 24925200, E 24925300; 1,9 kg:

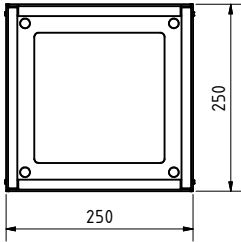

Aufsatzelement 250/250 var. BH 70-100 /  
gully top 250/250 var. height 70-100  
BG code: V 24925201, E 24925301; 2,6 kg:

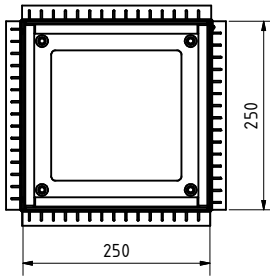

Aufsatzelement 250/250 var. BH 100-160 /  
gully top 250/250 var. height 100-160  
BG code: V 24925202, E 24925302; 2,9 kg:

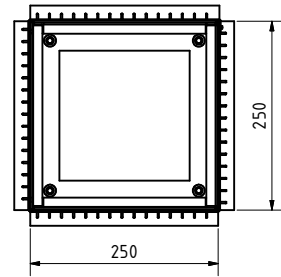
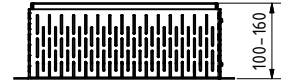

Aufsatzelement 400/400 BH 50 /  
gully top 400/400 height 50  
BG code: V 24940200, E 24940300; 2,4 kg:

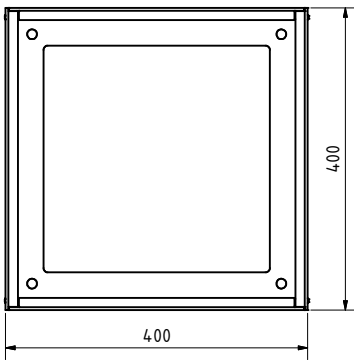

Aufsatzelement 400/400 var. BH 70-100 /  
gully top 400/400 var. height 70-100  
BG code: V 24940201, E 24940301; 3,3 kg:

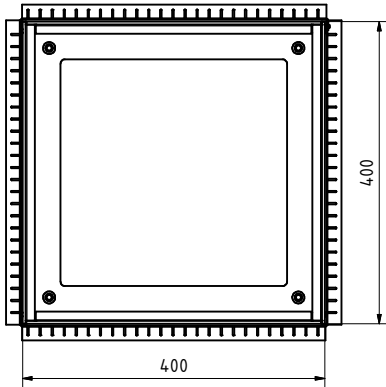

Aufsatzelement 400/400 var. BH 100-160 /  
gully top 400/400 var. height 100-160  
BG code: V 24940202, E 24940302; 4,1 kg:

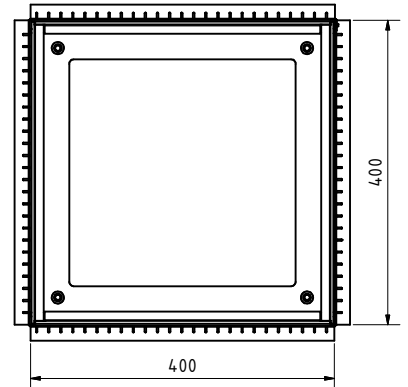
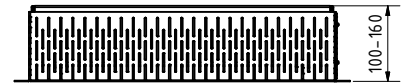

Gitterrost/ Mesh grating: MW 30/10  
BG code: V 24525200, E 24525300; 1,0 kg:

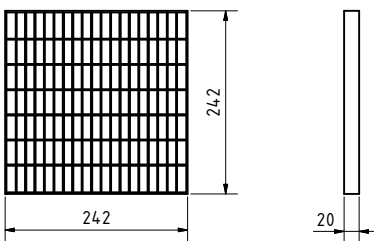

Gitterrost/ Mesh grating: MW 30/10  
BG code: V 24540200, E 24540300; 2,5 kg:

